

COVID19-Safety Measures

QNFCF cleanroom protocols and signage

New Protocols and Signage

- All members **MUST** complete the COVID-19 Safety Office Training at <https://uwaterloo.ca/safety-office/training/returning-campus-safely-during-covid-19>
- The Provincial self-assessment site is located here <https://covid19checkup.ca>
- High touch areas, for example Badger stations, entry keypads now sanitized twice daily
- Increased separation between cleanroom garments
- New limits on maximum occupancy in bays
- New training protocols
- Social distancing measures



Entry to the Cleanroom - 1

- One member allowed in the vestibule at any time
- Wait until vestibule is clear before entering
- Maintain University Covid19 distancing measures
- Clean your shoes and fob in as usual
- Please watch the following video demonstration:
<https://qnfcf.uwaterloo.ca/data/covid/nfcf-vid1.mp4/view>

Entry to the Cleanroom- 2

- On entry, immediately sanitise hands using the floor mounted dispenser by the door
- Proceed as normal to put on beard cover, hairnet, shoe covers and ensure you have safety glasses
- Please watch the video demonstration:
<https://qnfcf.uwaterloo.ca/data/covid/nfcf-vid2.mp4/view>

Entry to the Cleanroom- 3

- If you will be undergoing training with a staff member, please wear a **facemask** instead of the beard cover



Entry to the Cleanroom- 4

- Note that the Badger screen in the gowning area has been updated to show current occupancy against maximum occupancy in each bay



UNIVERSITY OF WATERLOO | Quantum NanoFab

Currently enabled tools:

UV Lithography Bay	Occupancy: 1/5	Wet Etch and Furnace Bay	Occupancy: 0/5
nnelsonf	REYNOLDSTECH-twincoater	Characterization Lab	Occupancy: 2/3
nnelsonf	YES-HMDS	lino.eugene	BRUKER-profilometer
E-Beam Lithography Bay	Occupancy: 2/4	s5gibson	BRUKER-AFM
lino.eugene	JEOL-EBL	s5gibson	JEOL-SEM
nnelsonf	RAITH-EBL	Packaging Lab	Occupancy: 0/2
Dry Etch & PVD/ALD/PECVD Bay	Occupancy: 1/5	Other	
m33scott	AJA-ionmill		
m33scott	OXFORD-SIRIE		
Deposition and Chemical Process Bay	Occupancy: 3/5		
m33scott	INTLVAC-Ebeam		
nnelsonf	PLASSYS-Ebeam		
pmcharles	PIRANHA		

Did you disable your equipment?

Entry to the Cleanroom - 5

- Wipe down personal items as you would normally
- Continue gowning following the usual procedure
- Before putting on cleanroom boots and stepping over the bench ensure that the next area is clear
- If clear, proceed to the glove station and entry to cleanroom as you would normally



In the Cleanroom – 1

- Observe direction arrows when walking in the main corridor to maintain physical distancing

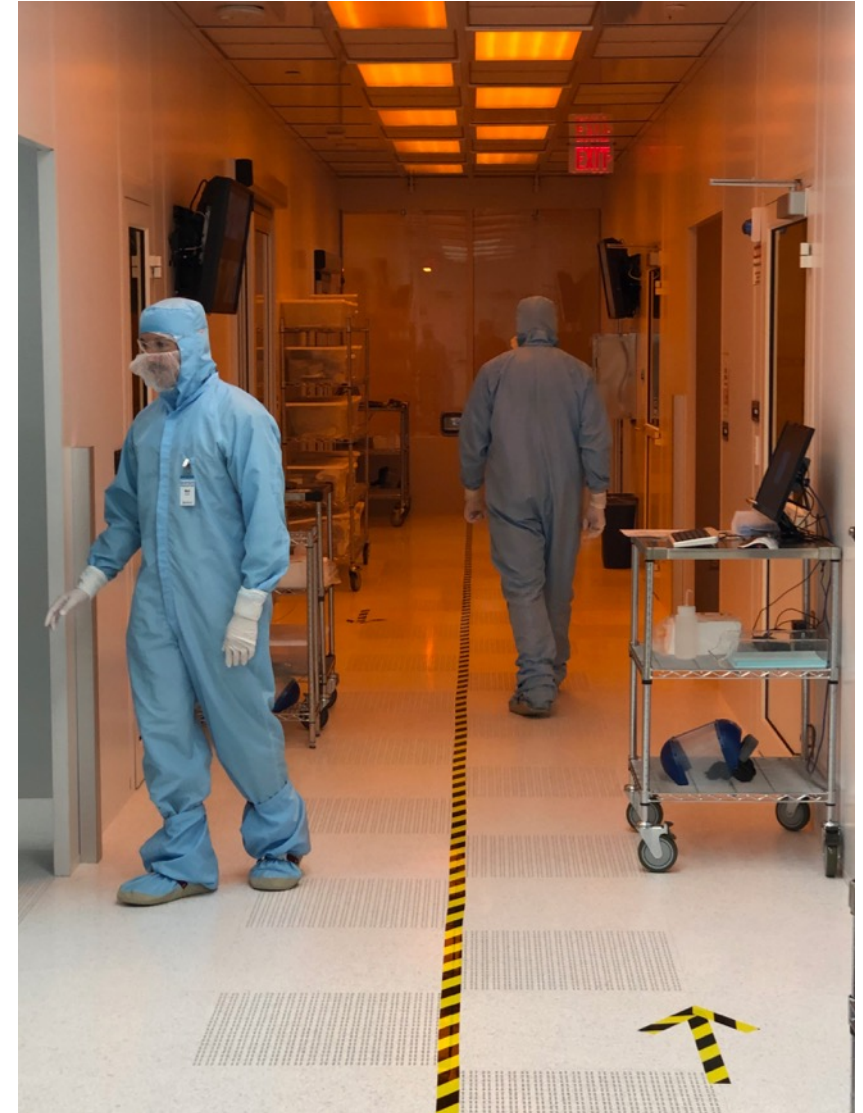

In the Cleanroom – Enabling a tool

- Enable tool in Badger
- Sanitise gloved hands using 70% IPA solution available on the lower shelf at the Badger station after you have enabled the tool

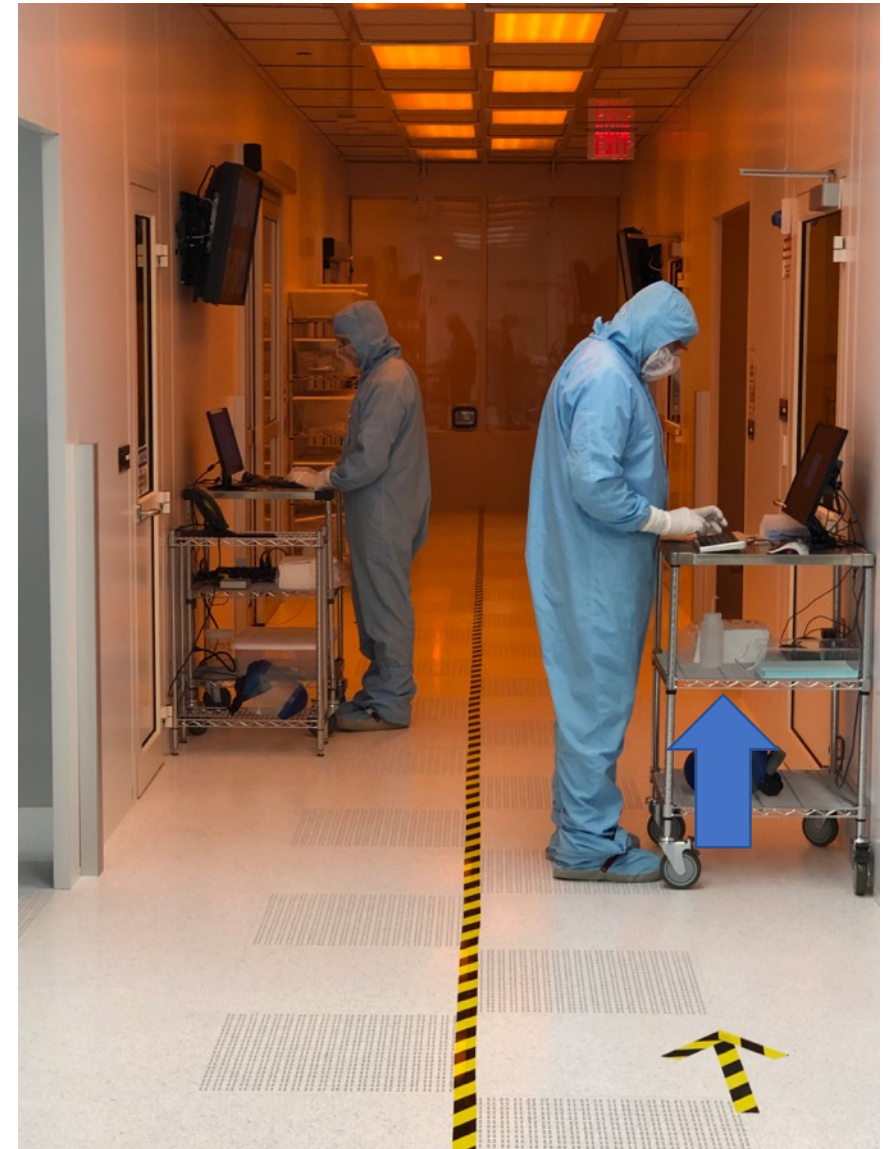
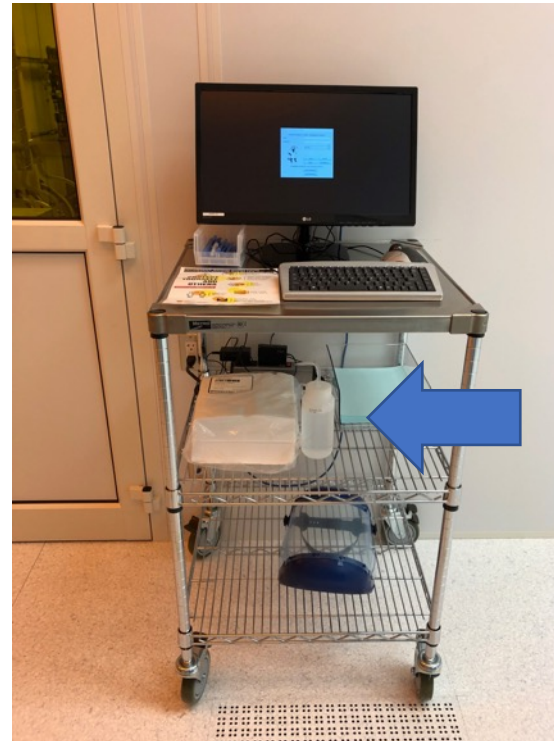

In the Cleanroom – accessing tools

- Before entry into any bay, check number of users against the maximum number of occupants displayed at the entrance to the bay



In the Cleanroom – Disabling a tool

- **Before** disabling tool in Badger, sanitise gloves with 70% IPA solution at the Badger station
 - Dispense a small amount of 70% IPA sanitizer onto a wipe and thoroughly wipe gloved hands
 - Dispose of the wipe in the solvent waste bin
 - Disable the tool in Badger



In the Cleanroom - gathering chemicals

- **Note we have new routes for gathering chemicals**
- Follow the route as shown on the map appropriate to the bay you are working in
 - In Photolithography bay - access chemical cabinets through rear door as usual
 - Solvent and Acid bays - use the new route through the service chase

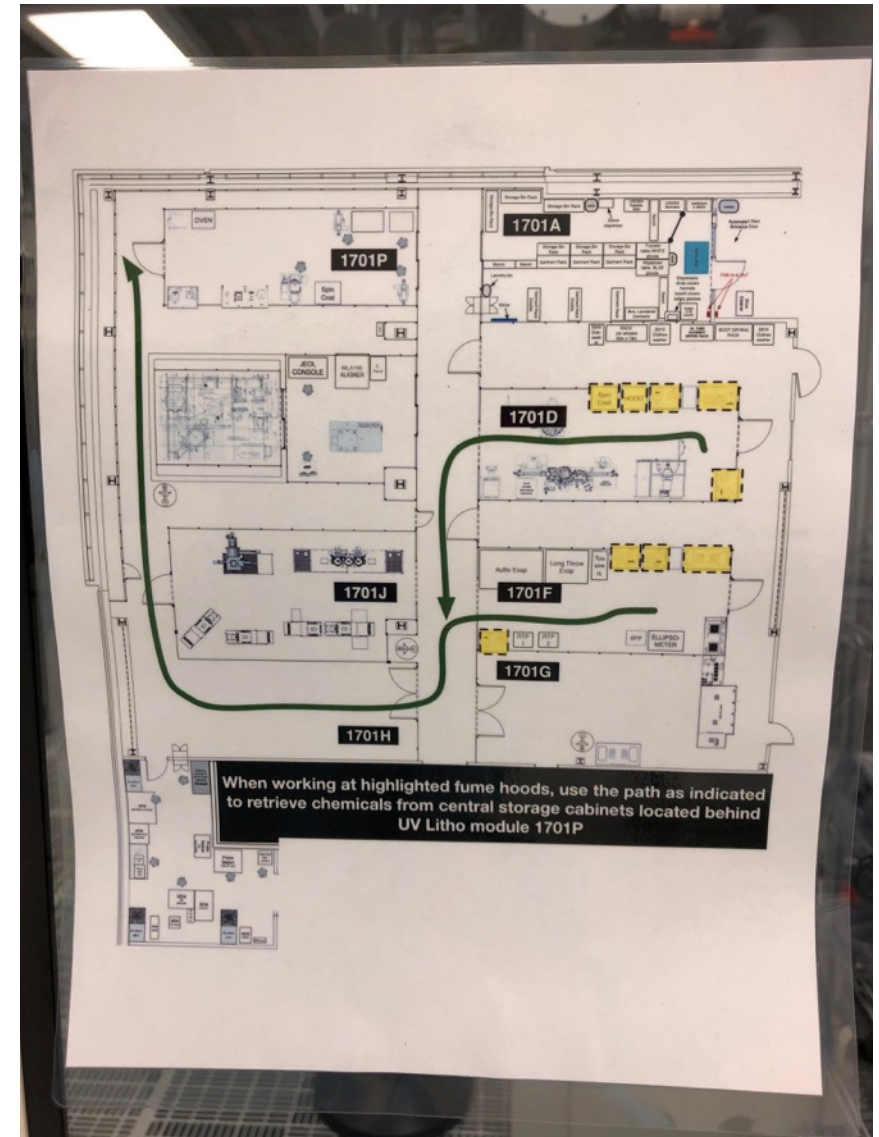

In the Cleanroom - Gathering chemicals



Stay on the marked path

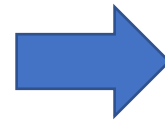
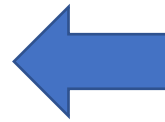

Exiting the Cleanroom

- Check gowning area to ensure that the **maximum occupancy of three** will not be exceeded by your entry
- Wait in the corridor or at cleanroom entrance until space is available
- Remove gloves and immediately sanitise hands – use floor mounted dispenser near glove station
- Before removing boots and stepping over bench ensure that area with hangers is empty
- Proceed to de-gown and exit cleanroom as normal



Thank you for your attention
and for helping us to maintain a
safe working environment